

彈弓頂針

SLING EJECTOR PIN

塑膠模用
Plastic mold accessories

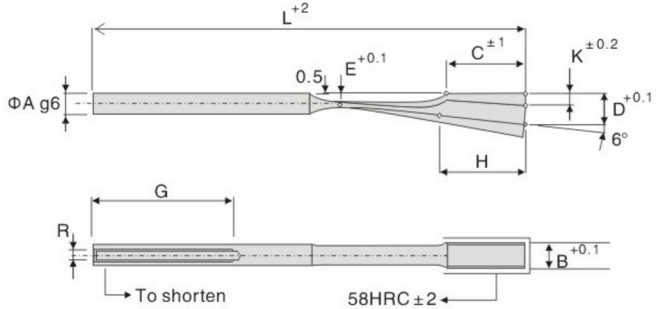

採用彈簧鋼製造，主要利用底部釋放彈性頂出所需角度，像標準頂針一樣，通過頂出板來實現其功能。

It's made from spring steel, release elasticity at bottom as standard ejector pins, and fulfill its function by eject plate.

Material M 材質	Hardness H 硬度
1.8159	HRC45° ± 3°

Type	尺寸/dimension									
	A	B	C	D	E	G	H	K	L	R
JHN01-1	6	6.2	22	9	3.5	40	25	3.5	125	M4
JHN01-2		8.2								
JHN01-3	8	8.2	25	11.5	4.5	50	30	4.5	140	M5
JHN01-4		10.2								
JHN01-5		12.2								
JHN01-6	10	14.2	30	15	5.5	60	38	5.5	175	M6
JHN01-7		16.2								
JHN01-8		18.2								

使用例Example

注意事項：

- 1.彈弓頂針支撐部件的長度必須與“H”尺寸一至。
- 2.調節部位的長度最少是“C”尺寸的1/3。
- 3.彈弓頂針伸出部位的尺寸必須等於或小于尺寸“C”。
- 4.任何時候，固定彈弓頂針的固定板的厚度不得低於15MM。

備注：如果此產品不能滿足你的要求，或者你在設計方面有什麼疑問，請聯系我的技術部門來尋求最佳解決方案。

Remark: If these products can not meet your need, or you have any question about our design, please contact our technical department to find the best solution.

1. The length of component which use to sustain sling ejector pin must be same as the size of "H"
2. The length of adjust part must at least 1/3 of the size of "C".
3. The size of protrude part in sling ejector pin must equal or small than the size of "C".
4. The thickness of locating plate of the sling ejector pin must more than 15mm at any time.

