

# 鎖模扣 Z174 LATCH LOCK

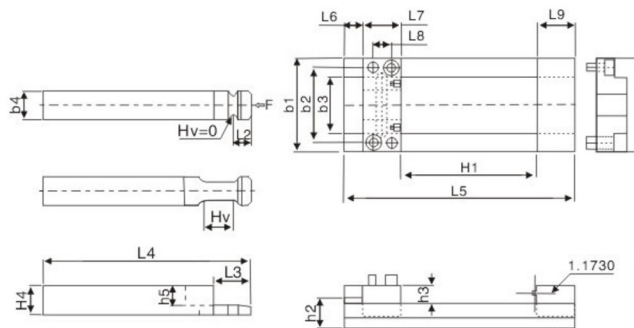

特點：安裝加工簡單，機械互鎖設計，安全可靠，連體式方型定位，使產品更精準。  
 可根據模具荷重選擇對應產品，在模板上至少要2套并對稱使用。使用溫度範圍120°C。  
 Characteristics: Installation and processing are simple. Design of mechanical interlock is safe and reliable. Connecting body and square positioning make product more accurate.  
 People can select corresponding product according to die load. There shall be at least 2 sets on template for symmetrical use. Operating temperature range is 120°C.



鎖模組件系列

Type	b1	H1	Hv	L5	L4	L3	L2	h5	h4	h3	h2	h1	b4	b3	b2	L9	L8	L7	L6	安裝螺絲	定位銷	F(N)	單價
Z174/50	50	90	0	140	140	20																	1000
			20			9.75	10	16	9.3	16	22.3	15	30.05	40	20	10	20	10	M4x12	6x20	16000		
			130	180	180	20																	
Z174/80	80	117	0	200	200	34																	1500
			32			16.75	13	12.3	9.3	22	30.3	20	45.05	60	34	16	34	15	M6x16	6x20	27000		
			167	250	250	109																	
Z174/100	100	145	0	250	250	45																	2150
			50			22.25	16	15.5	9.3	27	37.5	25	60.05	80	45	22	45	15	M8x18	8x24	48000		
			195	300	300	125																	

Order: Type No. x H1 x Hv x Pcs  
 Z174/50 x 90 x 0 x 10

## Example 使用例

